

# BLACK CREEK COMMUNITY FARM



## Community Kitchen & Resilience Hub: Executive Summary

January 2025







# 1. The Farm Today: A Decade of Growth

---

Black Creek Community Farm (BCCF) has emerged as a cornerstone of sustainable urban agriculture in Toronto, serving one of the city's most densely populated neighborhoods. Established in 2012, the farm spans eight acres adjacent to Black Creek Ravine. Over the past decade, BCCF has introduced key infrastructure, including greenhouses, an open-air pavilion, and pathways to support community programs. The farm cultivates three acres of certified organic vegetable fields, welcoming thousands of visitors annually for educational programs

and special events. Its facilities, including the historic Braeburn House, combine heritage preservation with functionality. However, limited parking, accessibility challenges, and insufficient year-round programming space constrain its full potential. The farm's evolution reflects a commitment to sustainable food production, environmental stewardship, and community engagement, positioning it as a unique asset within Toronto's urban landscape.





## 2. Unlocking Potential: Community Kitchen & Resilience Hub

---

The proposed Community Kitchen and Resilience Hub is central to BCCF's vision for expanded community impact. This facility will enable year-round programming, accommodating activities such as cooking demonstrations, food processing, and educational workshops. Located near the farmyard, the hub will enhance farm-to-table initiatives while supporting local food security and climate resilience efforts. The design allows the space to host diverse events, from school visits to emergency community support during extreme weather events.

By integrating sustainable technologies such as solar panels and rainwater harvesting, the hub aligns with BCCF's environmental values. These improvements will transform BCCF into a dynamic center for community education, empowerment, and environmental sustainability, increasing its capacity to serve the surrounding community while addressing critical urban food system challenges.



### 3. Key Program Elements

The Community Kitchen and Resilience Hub will feature a thoughtfully designed mix of spaces to enhance functionality and accessibility. Key elements include a generously sized kitchen for food preparation, teaching, and community events, complemented by support spaces like a pantry, walk-in cooler and freezer, and a dish-cleaning area. A central gathering space will accommodate up to 60 people, with sliding doors connecting to outdoor porches for additional flexibility. The building will also include accessible public washrooms and storage for

programming materials. Sustainable infrastructure such as photovoltaic panels and rainwater harvesting cisterns will support operations while showcasing green design practices. Adjacent site improvements, including expanded parking, pathways, and landscaping, will ensure the hub integrates seamlessly with the farm’s existing amenities and enhances visitor experience.

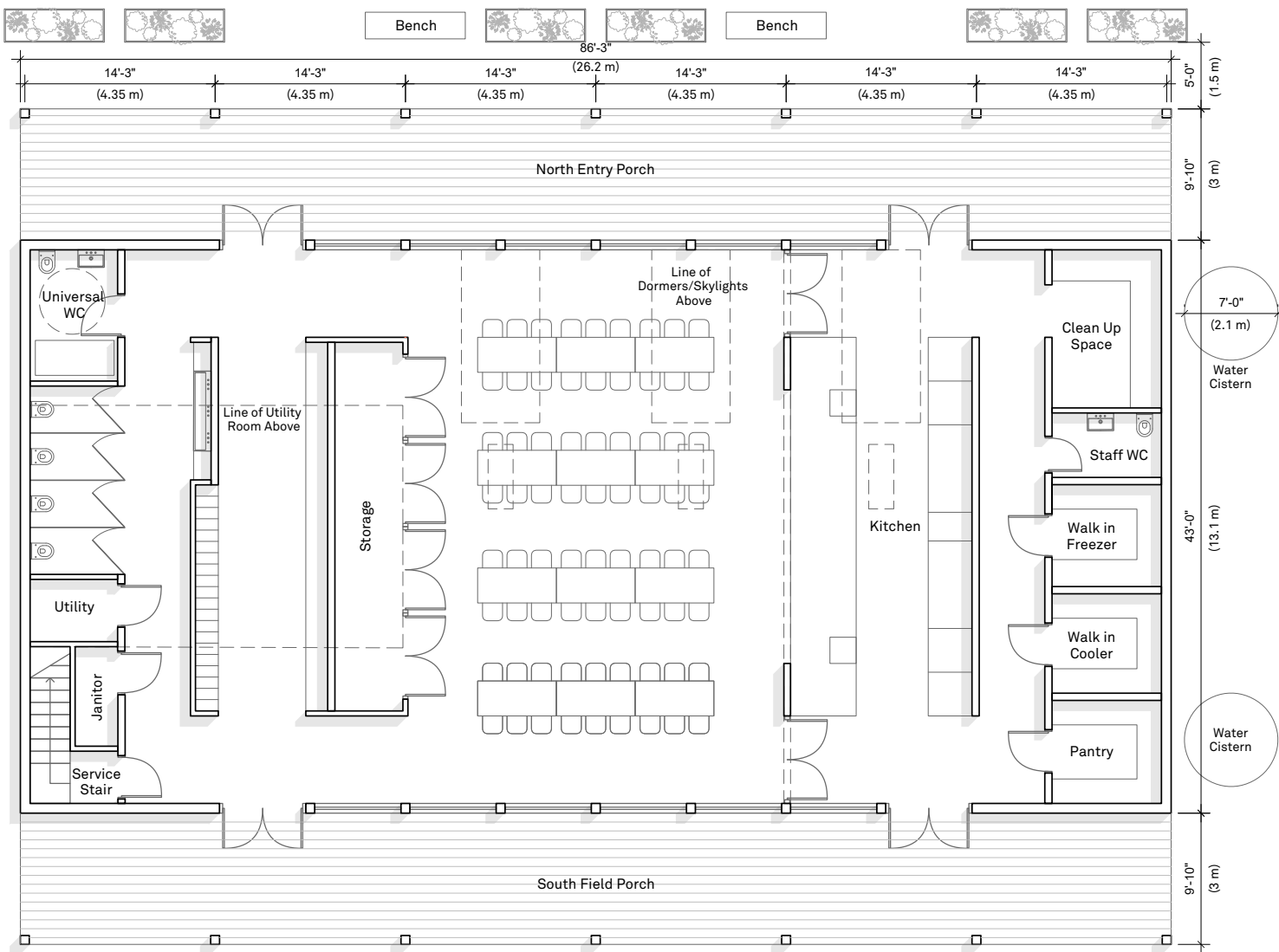

Kitchen Hub Plan



## 4. Imagining the Future: Visualizing Improvements

BCCF's proposed enhancements are brought to life through detailed visual concepts. The relocation of greenhouses to the farm's southern boundary will allow for a more spacious and functional central farmyard, capable of hosting events and supporting daily operations. Improvements to site access include widening the primary entry drive and adding signage along Jane Street, increasing visibility and convenience for visitors. The Community Kitchen and Resilience Hub, designed with a barn-like aesthetic, will feature large windows, porches, and sustainable materials to blend harmoniously with the farm's rural character. Enhanced parking, pedestrian pathways, and outdoor gathering spaces will create a welcoming and accessible environment for diverse user groups, from schoolchildren to event participants, reinforcing the farm's role as a community focal point.

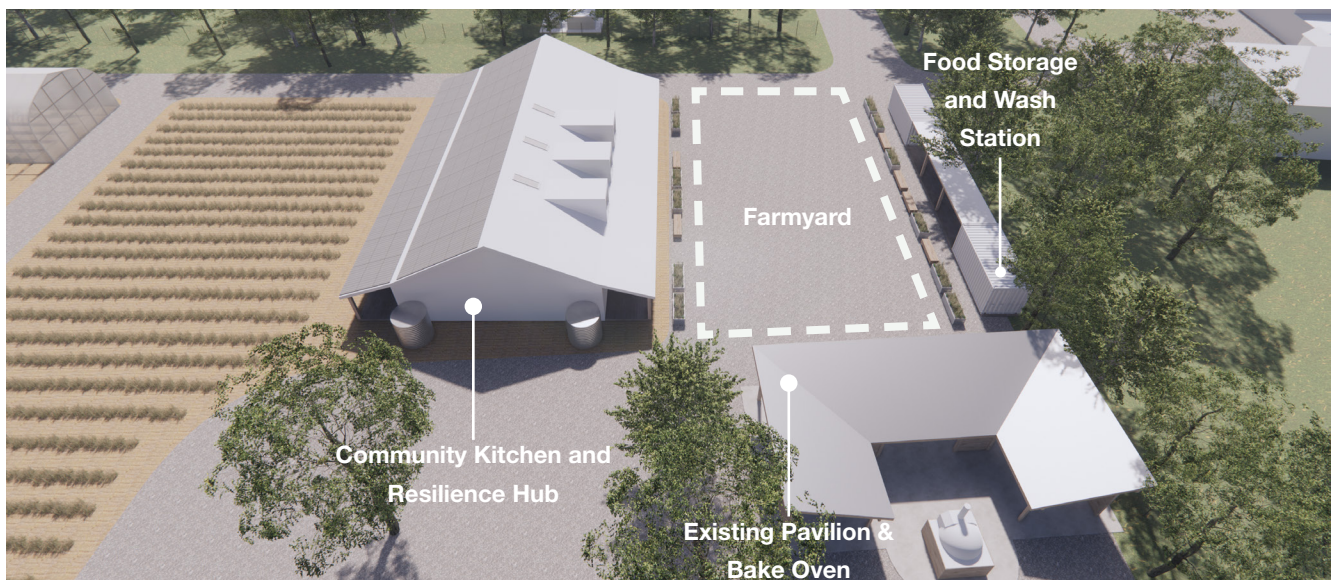



## 5. The Case for Support

The Black Creek Community Farm improvements represent a significant opportunity to amplify its impact on the community and environment. The estimated \$5.6 million project cost includes construction, sustainable infrastructure, and site enhancements. This investment will enable BCCF to expand its reach, increasing capacity for educational programming, food security initiatives, and climate resilience efforts. Funding will also support infrastructure improvements essential for the farm's long-term viability, such as expanded parking and improved accessibility. As Toronto's largest urban farm, BCCF is uniquely positioned to demonstrate the transformative power of sustainable urban agriculture. This project presents an opportunity for donors and partners to contribute to a legacy of community empowerment, environmental stewardship, and food justice, ensuring BCCF's continued growth and impact.



OVERALL PROJECT COORDINATION



RESILIENT CITIES CATALYST

DESIGN TEAM

JLA

PUBLICCITY

TYLin

 Introba

Blackwell



Ingersoll  
& associates inc.

**BLACK CREEK COMMUNITY FARM**

Community Kitchen & Resilience Hub

<http://blackcreekfarm.ca/communityhub>

**BLACK CREEK**  **COMMUNITY FARM**



RESILIENT CITIES CATALYST

JLA

PUBLICCITY

January 2025